

# Structure and Function in Living Systems

Name: \_\_\_\_\_

## Biological Organization

Period: \_\_\_\_\_

On the diagram below, figure out the correct label for each level of organization in a human body. The labels are currently out of order. Use Chapter 4, Section 3 to help you. Ignore the letters with the numbers next to them.

Now, in the box with the tall arrow, add the words **smallest** and **largest** on the correct lines to show how the size of the levels is changing. Next, choose a different colored pencil for each level, and lightly color the square with that capital letter in the label box. Then, lightly color the part of the diagram that matches that letter with the same color. For example, the G box below and the person to the right should be done in the same color.

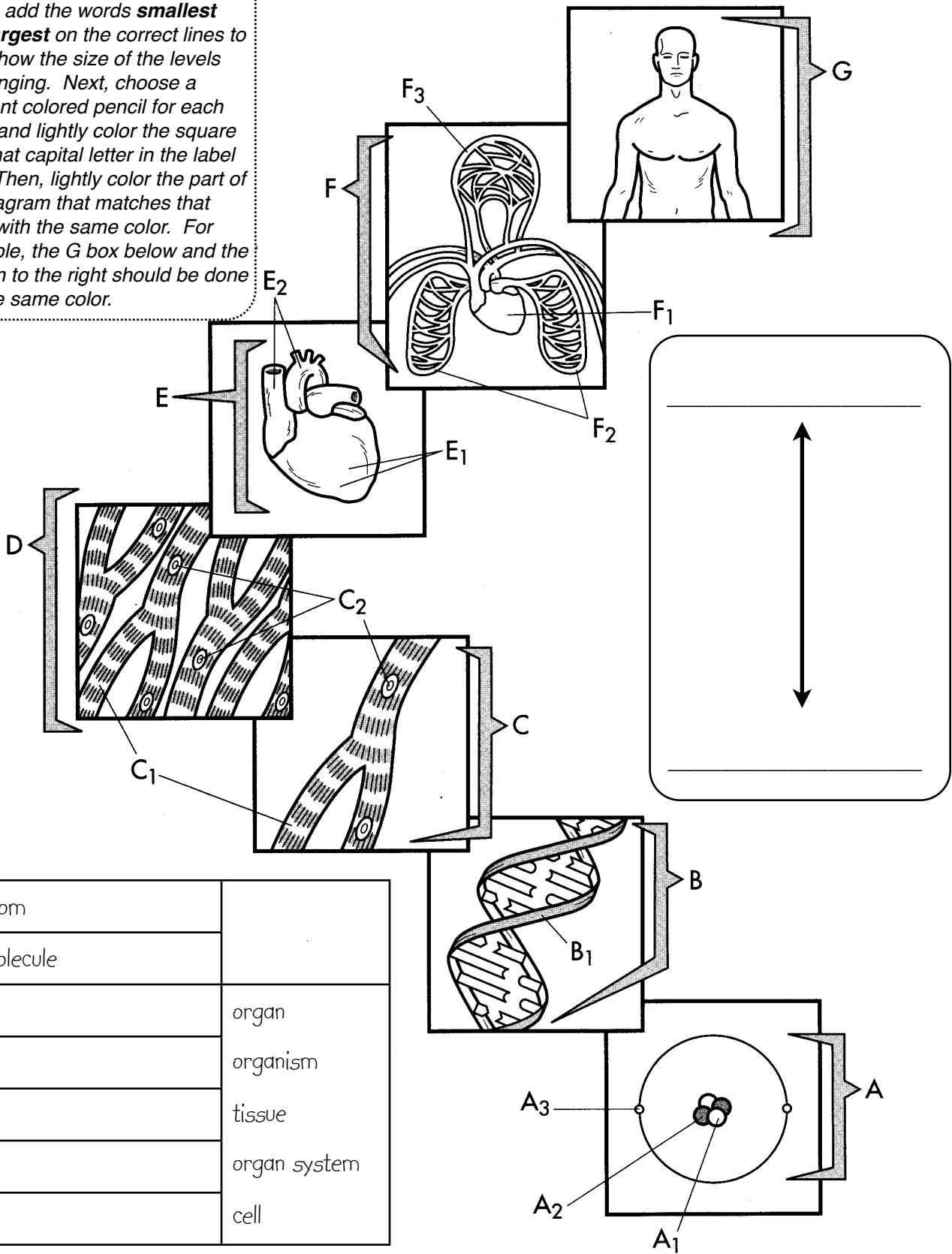

<b>A</b>	atom	
<b>B</b>	molecule	
<b>C</b>		organ
<b>D</b>		organism
<b>E</b>		tissue
<b>F</b>		organ system
<b>G</b>		cell